



ALLURE

The Minimal Thermal Break
Sliding Door System



TODAY FOR TOMORROW

KOEMMERLING, MAKING BIG DIFFERENCE IN OUR LIVES

Koemmerling carries the legacy of more than a century built on a distinct identity and high-quality products made from cutting-edge technology while focussing on aesthetic aspects. We have positioned ourselves in the industry as a leading brand that stays ahead on trends with innovation and ingenious technology by keeping future in focus.

PEOPLE PASSION PROFILES

TODAY'S WINDOWS FOR TOMORROW'S WORLD

Koemmerling is a prominent global player, renowned for being one of the strongest and most recognized brands in the uPVC window and door industry worldwide. Our products are distributed to over 100 countries, showcasing our commitment to excellence. With a wealth of industry expertise and a focus on product quality, Koemmerling is dedicated to providing cutting-edge solutions in aluminum windows and doors to enhance human lifestyles and elevate construction industry standards globally. Embodying innovation, Koemmerling has always been and will continue to be a driving force for advancement within the window and door systems sector. Our dedicated engineers and researchers continuously strive to develop systems that meet current needs while adapting to evolving trends. As a responsible brand, we embrace new challenges with meticulous care and dedication to ensure excellence in all endeavors.

Legacy

Innovation

Global Presence

Local Solutions

Advantages & Innovation

Koemmerling aluminum window and door systems provide top-notch quality and security. These systems are designed to maintain flawless functionality while preserving aesthetics and surface finish for extended durability. With exceptional weather resistance, they offer long-term reliability with minimal maintenance needs. These systems excel in addressing various architectural challenges related to color, shape, and design. Koemmerling boasts a century-long legacy with a distinctive identity.



Thermally insulated doors are specially designed doors that help maintain a consistent temperature inside a building by reducing heat transfer between different areas. These doors are commonly used in commercial and industrial settings where energy efficiency and temperature control are crucial.



Allure system is specially designed door to withstand the force of high winds and protect the interior of the building from damage. This **high wind-resistant** sliding door system uses high grade aluminium to produce impact-resistant panels, robust locking mechanisms, and weather-stripping to prevent air and water infiltration.



Air-tight windows work by sealing tightly when closed, preventing outside air - along with dust particles - from seeping into your home. These windows are designed to fit snugly within their frames, eliminating the gaps that are often present in older or poorly fitted windows



Aluminium is a **highly recyclable material**, which means that it can be repurposed and reused multiple times without losing its quality. By opting for recyclable aluminium doors and windows, you are contributing to the reduction of waste and the conservation of natural resources.

Customer Focus

We hold our customers in high regard and are dedicated to providing cutting-edge products and services efficiently and with great skill. Our focus is on sustainable growth, and we have effectively built strong, long-lasting relationships with customers based on trust and core values. The expanding clientele we serve reflects our commitment to innovation, quality, and environmental responsibility. Our extensive selection of advanced window and door systems perfectly complements contemporary architecture, meeting customer's evolving needs promptly and with tailored solutions.



TODAY FOR TOMORROW

ALLURE

The Minimal Thermal Break Sliding Door System

Allure, the minimal thermal break sliding door system stand out as a top choice for homeowners, architects, and builders due to their premium, elegant, seamless, and slim design. Their sleek appearance is a major draw, featuring cleanlines and minimalist aesthetics that effortlessly enhance any property's overall look. With concealed slim frames, robust hardware, and expansive glass panes, these doors exude a contemporary and sophisticated charm that elevates the value of any space they adorn.

Beyond their visual appeal, the practical benefits of these doors are engineered to promote energy efficiency and temperature regulation within buildings. By minimizing heat transfer between different areas, they aid in maintaining a consistent indoor temperature. The advanced insulation technology in Allure system plays a key role in reducing heat loss during winter months and curbing heat gain in the summer. This not only leads to lower energy expenses but also fosters a more pleasant and comfortable indoor atmosphere for occupants. By saving on energy costs, these doors promote energy conservation, fostering harmony between the environment and human lifestyle, a crucial need in our modern world.

Slimline interlock of 24 mm sideline

Maximum single panel size 2.5m (w) x 4.5m (h)

Maximum wind load 3.5 kpa

90° Corner sliding system

U values- till 1.3 W/m²K

Water tightness – 600pa



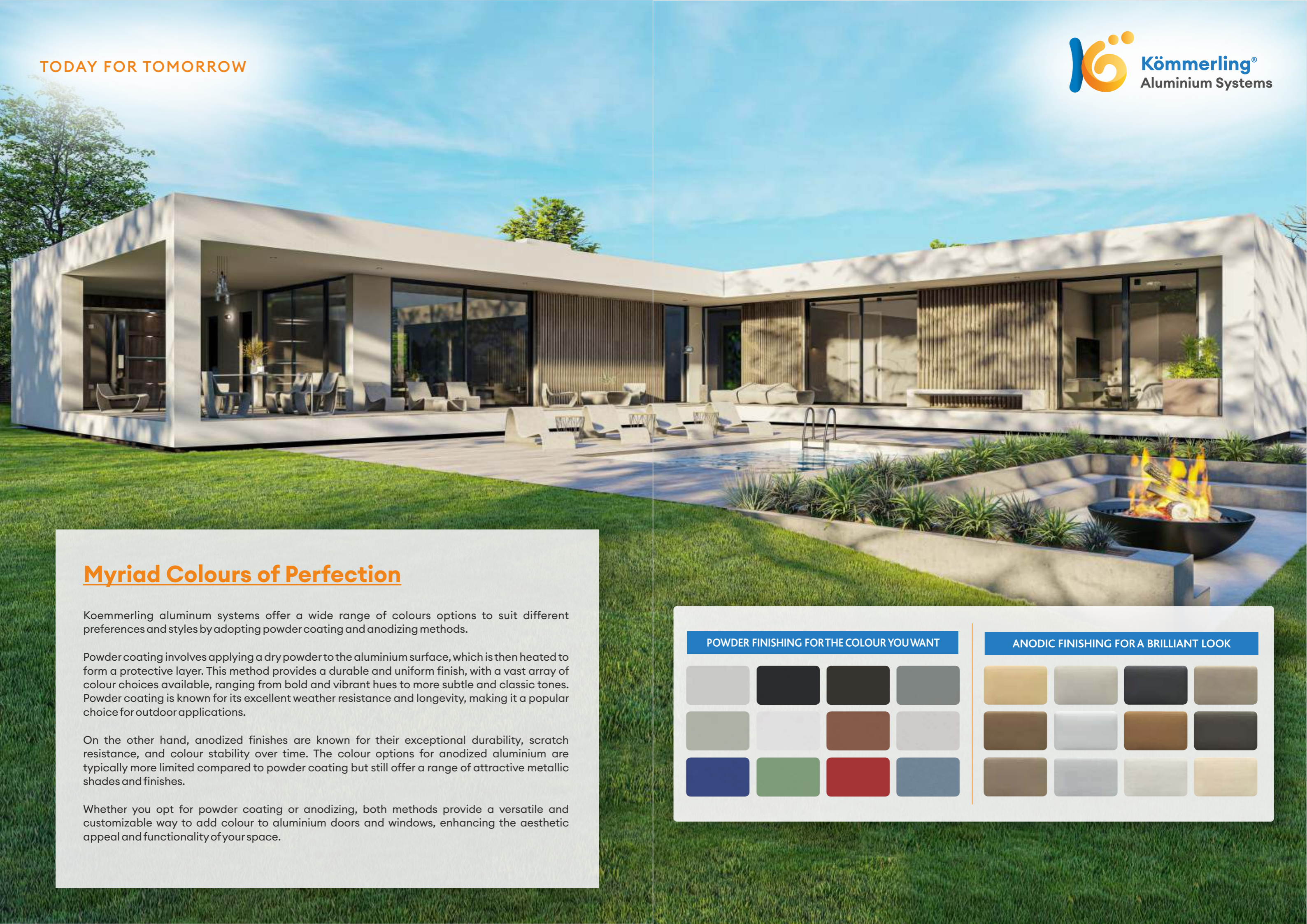

Myriad Colours of Perfection

Koemmerling aluminum systems offer a wide range of colours options to suit different preferences and styles by adopting powder coating and anodizing methods.

Powder coating involves applying a dry powder to the aluminium surface, which is then heated to form a protective layer. This method provides a durable and uniform finish, with a vast array of colour choices available, ranging from bold and vibrant hues to more subtle and classic tones. Powder coating is known for its excellent weather resistance and longevity, making it a popular choice for outdoor applications.

On the other hand, anodized finishes are known for their exceptional durability, scratch resistance, and colour stability over time. The colour options for anodized aluminium are typically more limited compared to powder coating but still offer a range of attractive metallic shades and finishes.

Whether you opt for powder coating or anodizing, both methods provide a versatile and customizable way to add colour to aluminium doors and windows, enhancing the aesthetic appeal and functionality of your space.

POWDER FINISHING FOR THE COLOUR YOU WANT

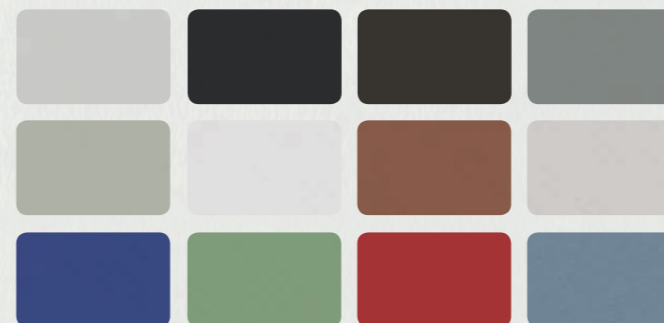

ANODIC FINISHING FOR A BRILLIANT LOOK



2 Track 2 Shutter Sliding Door System

Top Vertical Cross Section

Side Cross Section

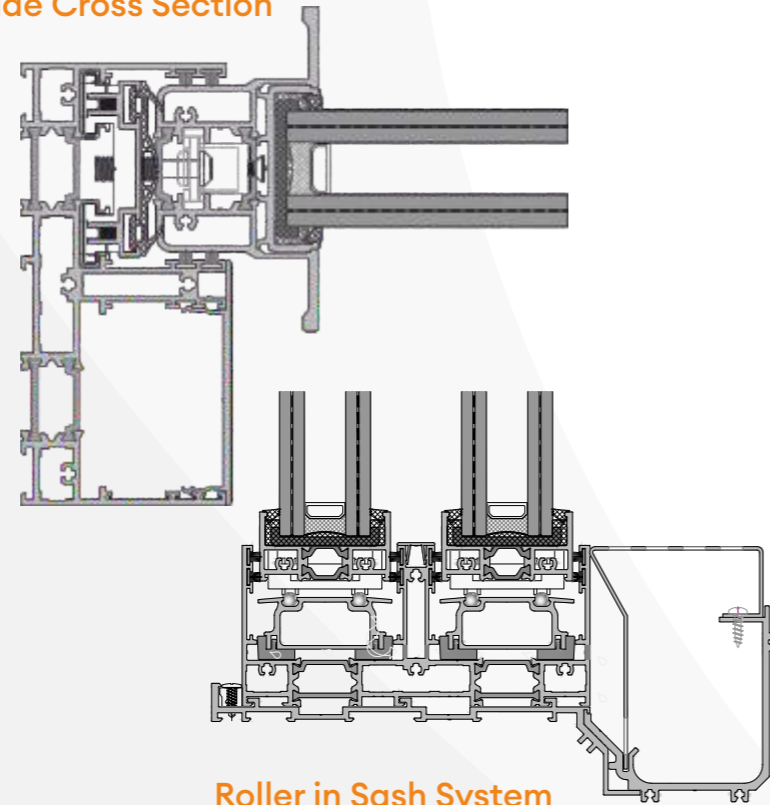
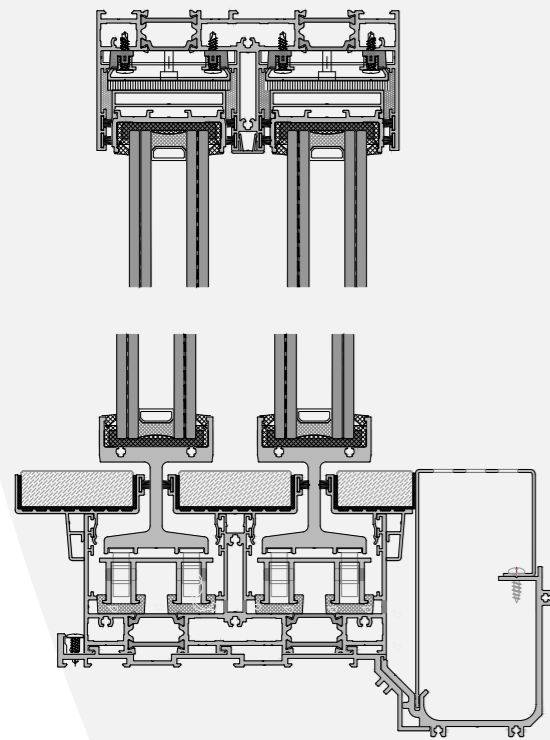

Concealed Track System

Roller in Sash System

3 Track 3 Shutter Sliding Door System

Top Vertical Cross Section

Side Cross Section

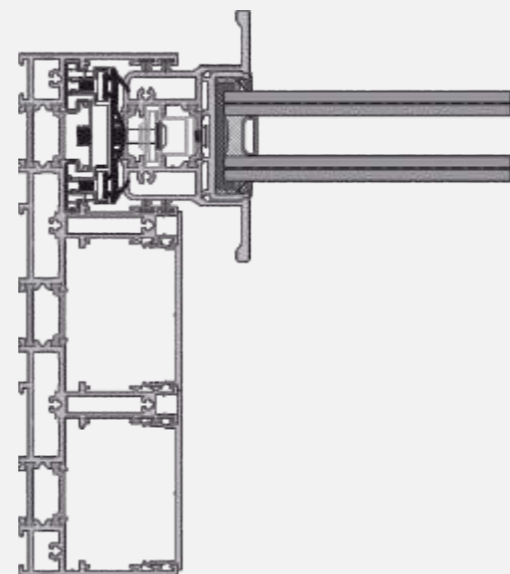
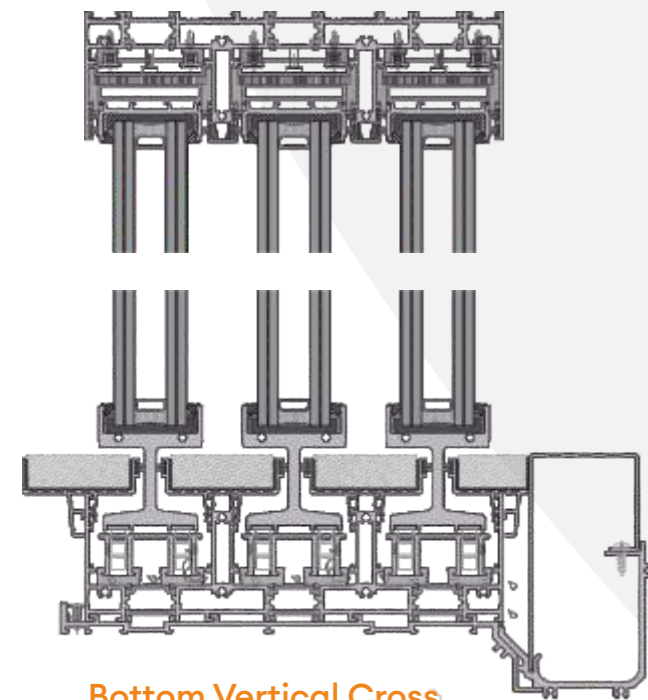

Bottom Vertical Cross Section

Interlock Combinations

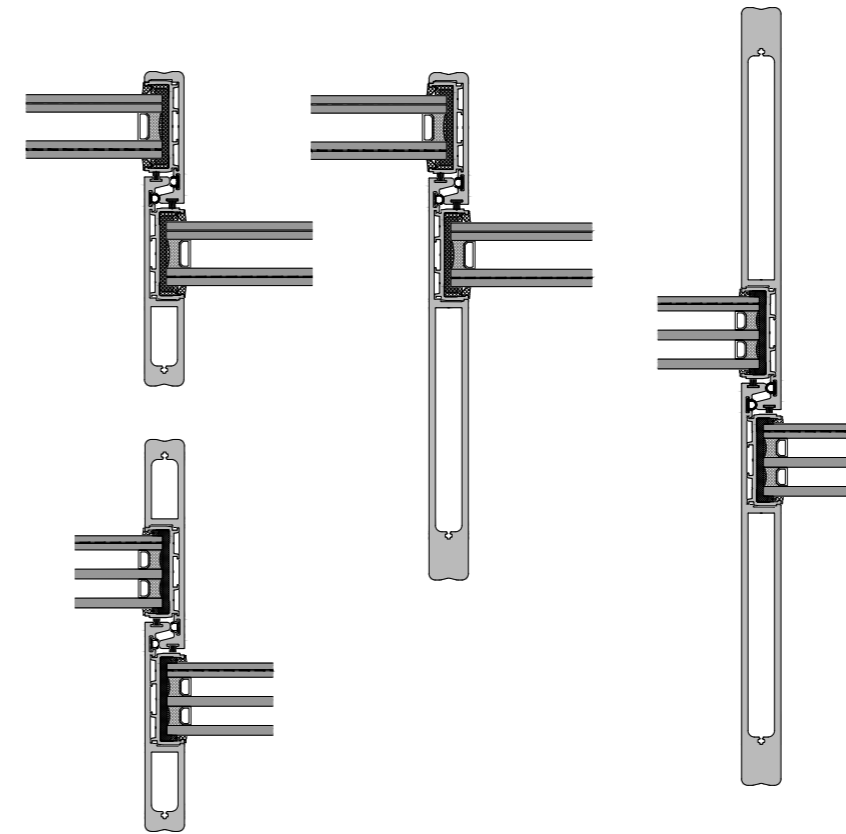

90° Outer Corner Section

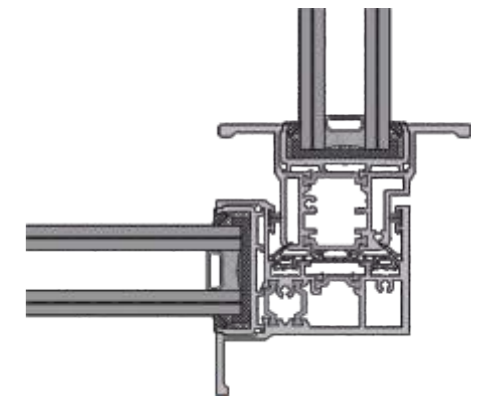

Door Typology

2 Track 2 Shutter

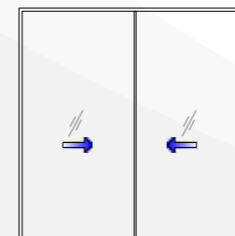

2 Track 4 Shutter

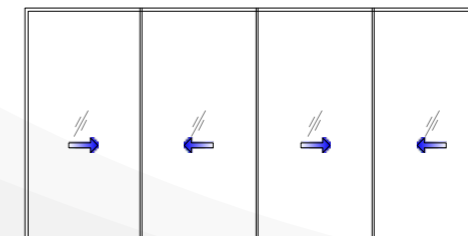

3 Track 3 Shutter

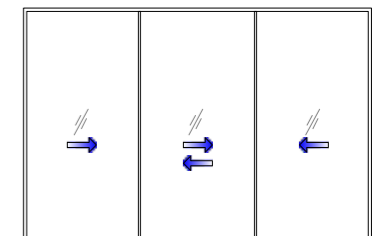

3 Track 6 Shutter

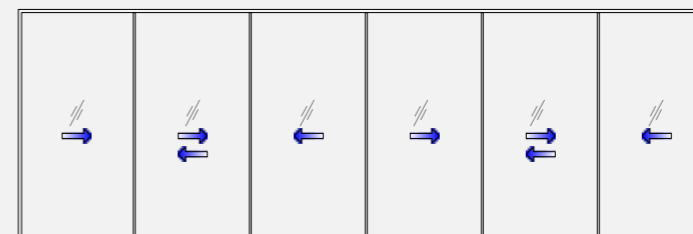

90° 2 Track 2 Shutter

